

SERIES 34E Sealed Surface Mount Toggle Switches

FEATURES

- Save Space and Weight
- SPDT Circuitry
- Choice of Actuators and Terminations

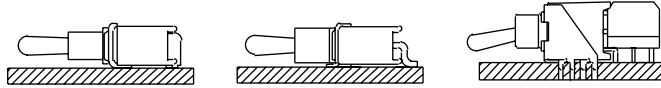

MODELS In inches (and millimeters)

SPDT

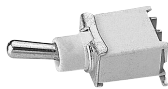

M6
Termination
Option

Model No.	Switching Position		
WMSP1	ON	NONE	ON
WMSP2	ON	NONE	(ON)
WMSP3	ON	OFF	ON
WMSP4	(ON)	OFF	(ON)
WMSP5	ON	OFF	(ON)
Term. Comm.	2-3	OPEN	2-1

Schematic D2Comm. () = Momentary

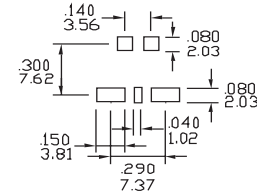
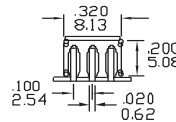
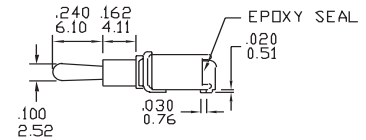
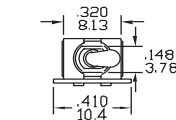

SPDT



S6
Termination
Option

Model No.	Switching Position		
WMSP1	ON	NONE	ON
WMSP2	ON	NONE	(ON)
WMSP3	ON	OFF	ON
WMSP4	(ON)	OFF	(ON)
WMSP5	ON	OFF	(ON)
Term. Comm.	2-3	OPEN	2-1

Schematic D2Comm. () = Momentary

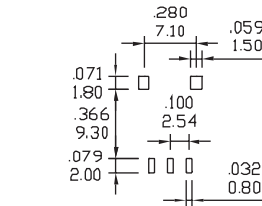
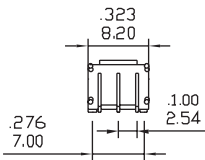
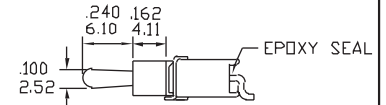
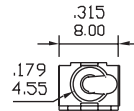

SPDT



M7
Termination
Option

Model No.	Switching Position		
WMSP1	ON	NONE	ON
WMSP2	ON	NONE	(ON)
WMSP3	ON	OFF	ON
WMSP4	(ON)	OFF	(ON)
WMSP5	ON	OFF	(ON)
Term. Comm.	2-3	OPEN	2-1

Schematic D2Comm. () = Momentary

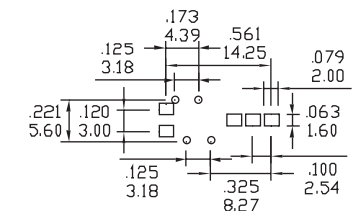
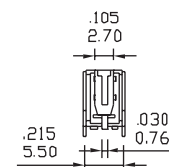
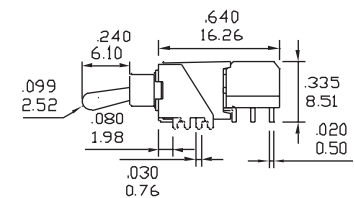
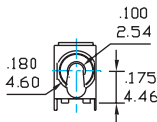

ACTUATOR OPTIONS In inches (and millimeters)

<p>1 For S6, M7 Termination Options Only</p> <p>F</p>	<p>2</p>	<p>3 ESD Resistant Plastic Toggle</p>	<p>4 ESD Resistant Plastic Toggle</p>
---	-----------------	--	--

TERMINATION OPTIONS In inches (and millimeters)

<p>M6</p>	<p>S6</p>	<p>M7</p>
------------------	------------------	------------------

TAPE AND REEL PACKAGING In inches (and millimeters)

For M6 and S6 Termination Options Only

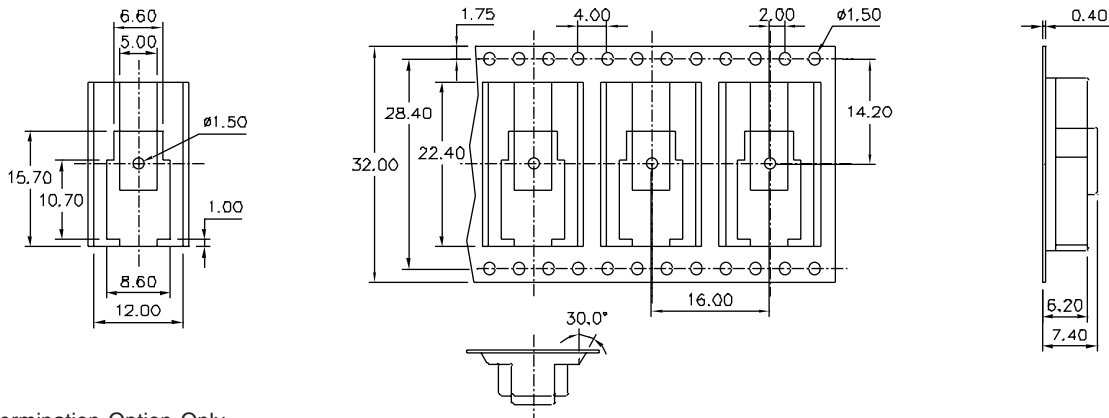

For M7 Termination Option Only

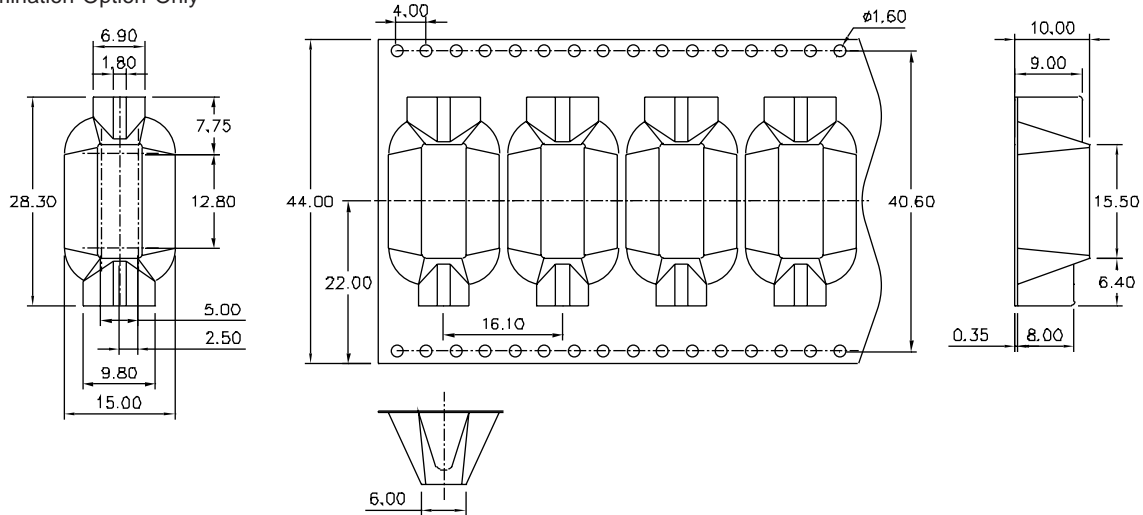

SPECIFICATIONS

RATINGS

Contact Rating: 0.4 VA max. @ 20V max. (AC or DC)

Mechanical and Electrical Life: 30,000 make-and-break cycles at full load

Contact Resistance: 20 milliohms max. typ. initial @ 2-4 VDC, 100 mA

Insulation Resistance: 1,000 megaohms minimum

Dielectric Strength: 1,500 V RMS @ sea level

Operating Temperature: -30°C to 85°C

MATERIALS

Case and Bushings: Glass-filled nylon 4/6,

flame retardant, heat stabilized (UL94V-0)

Actuator: Brass, chrome plated

Contacts: Copper alloy, gold plate over nickel plate

Terminals: Copper alloy, tin-lead alloy over nickel palte

Terminal Seal: Epoxy

ORDERING INFORMATION

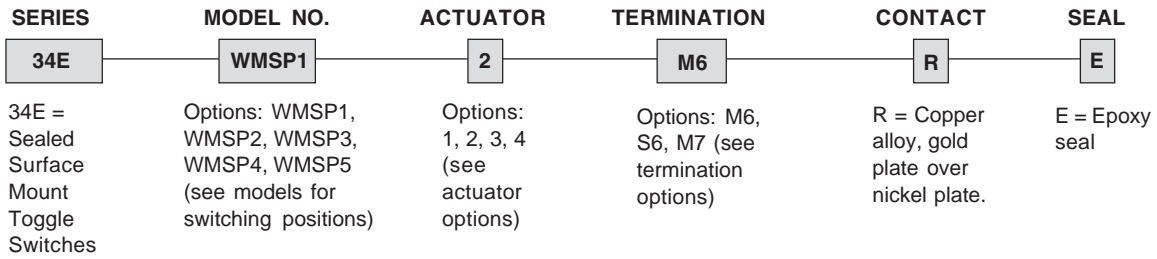

Example Part Number: 34EWMSP12M6RE

Available from your local Grayhill Component Distributor. For prices and discounts, contact a local Sales Office, an authorized local Distributor In Beijing, CHINA, Phone: (010)6858-5001, Fax: (010)6851-9889, Http://www.hmcs.com.cn